

Installation Manual

Light Duty and Heavy Duty Single Screen Monitor Support

Single light duty (5-20 lbs capacity)
Single heavy duty (10-30 lbs capacity)

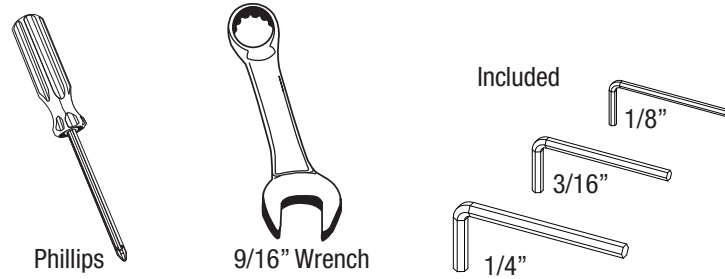

INSTALLATION WARNINGS:

- Read the entire instruction manual before beginning any installation or assembly
- The installer must verify that the attachment surface can safely support the combined weight of all the attached equipment and hardware
- Improper installation of this equipment may cause extensive property damage or serious personal injury, either during or after installation

DISCLAIMER:

- The manufacturer and/or distributor will bear no responsibility for any damages of any kind arising from any improper installation of this product
- In no way will the manufacturer and/or distributor be held liable for any damage to the monitor, property or personal injury should any excessive force either intentionally or unintentional be applied to the monitor or monitor support assembly

Box Contents - Arm Assembly

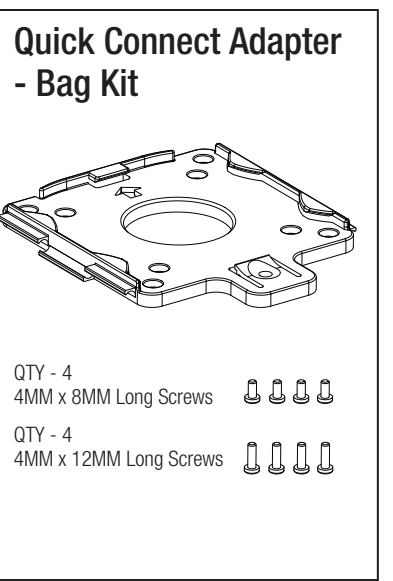
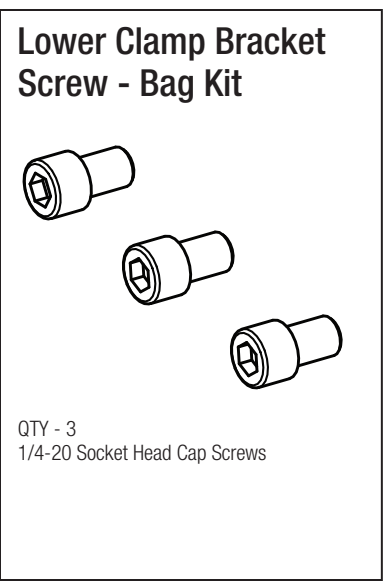
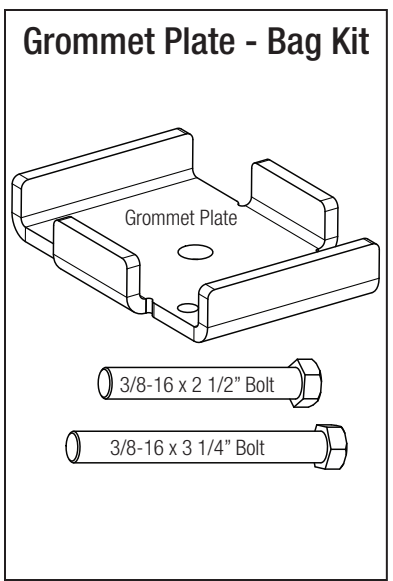
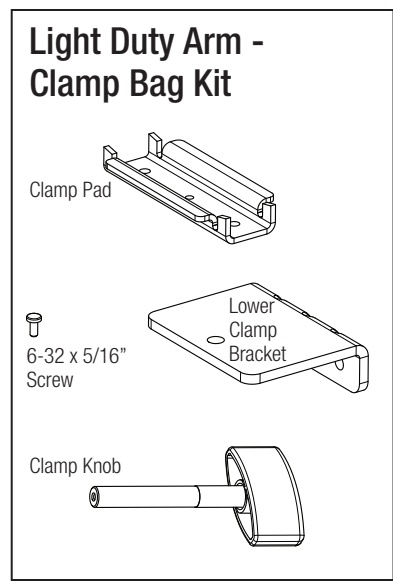
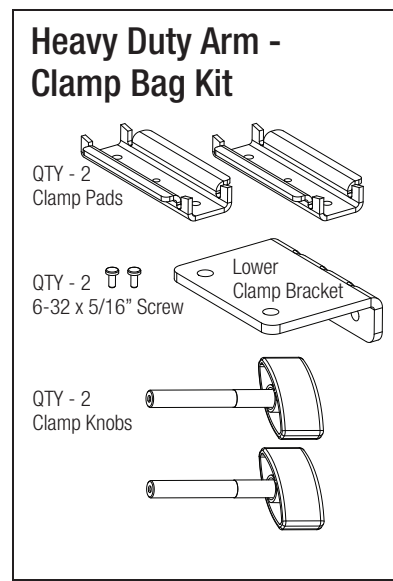
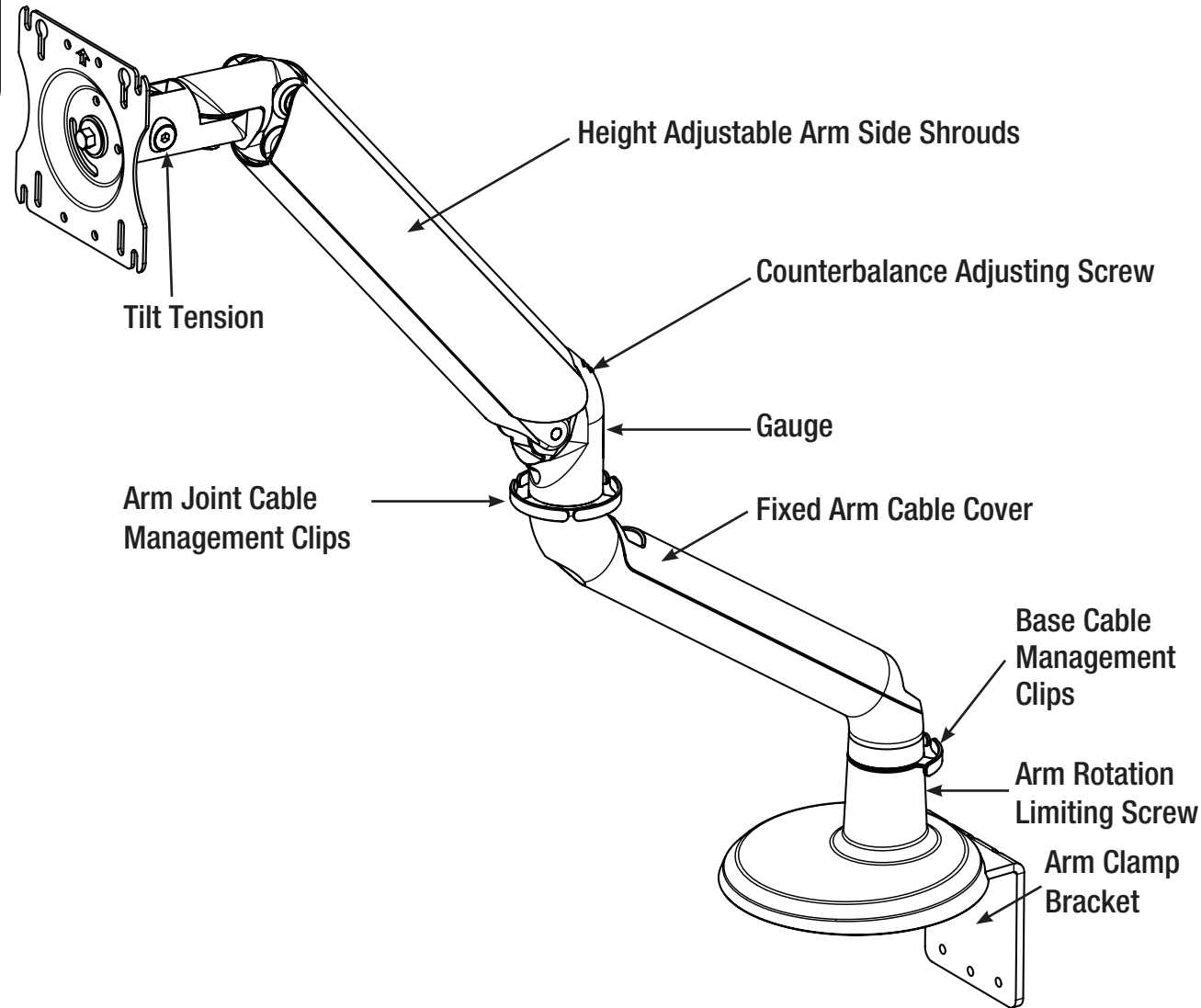

Clamp Mounting the Arm to the Work Surface (Light and Heavy Duty):

1. Screw the clamp knob/s into the threaded hole/s in the lower clamp bracket
 2. Using the 6-32 x 5/16" long screw/s, attach the clamp pad/s to the clamp knob/s
 3. Attach the lower clamp bracket assembly to the arm clamp bracket with the three 1/4-20 Socket Head Cap Screws using the 3/16" Allen Key
 4. Position the arm assembly onto the work surface and securely clamp to the work surface by tightening the clamp knob/s
- NOTE:** For panel systems where the assembled clamp cannot be attached as an assembly. Slide the arm clamp bracket in the space between the rear of the desk and panel system, then attach the lower clamp bracket to the arm clamp bracket using the three 1/4 - 20 socket head cap screws. Tighten the clamp knob/s to securely clamp to the work surface.

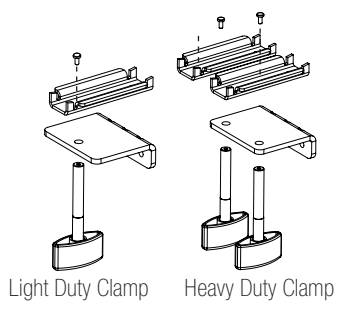

Grommet Mounting the Arm to the Work Surface:

1. Using a Phillips screw driver, remove the two countersunk screws which attach the arm clamp bracket to the base of the monitor arm assembly
2. Lay any monitor cables through the grommet hole on the work surface
3. Align the base of the monitor arm assembly over the grommet hole on the work surface, passing any cables under the rear cut-out in the arm base
4. Depending on the thickness of the work surface insert either the 3/8-16 x 2 1/2" bolt or 3/8-16 x 3 1/4" bolt through the centre hole of the grommet plate, with the flanges facing up. Insert the threaded end of the 3/8" bolt through the grommet hole and into the threaded hole in the arm base & tighten securely with a 9/16" wrench or socket

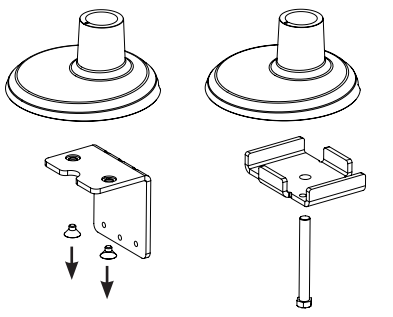

Mounting the Monitor:

1. Attach the quick connect adapter to the rear of the monitor using the 4mm screws provided. Make sure the arrow on the adapter is pointing to the top of the screen
2. With the arrow pointing up, slide the adapter bracket onto the arm VESA Plate until the bottom tab clicks onto the VESA plate
3. To remove the monitor, depress the tab to remove from the VESA bracket assembly

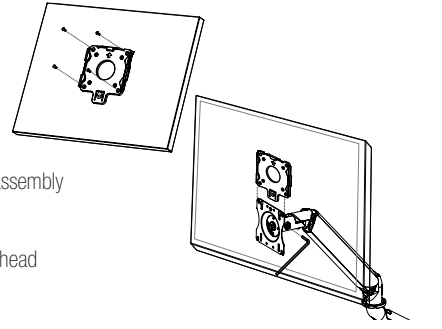

Adjusting the tilt tension:

If the monitor drops or is too tight, adjust the tension screw at the side of the head using the 3/16" Allen key

Base Cable Management

- Pass the cables that extend from the rear of the desk through the two cable management clips situated between the base and fixed height arm

Fixed Arm Cable Management

- Remove the fixed arm cable cover by pulling to detach from the arm. Lay the cables into the trough on the cable cover and carefully re-attach the cover to the arm, then insert the cables into the cable clips at the arm joint

Height Adjustable Arm Cable Management

- Pull to remove the left and right side cable shrouds and lay the cables into side shroud trough. Carefully replace the side shrouds ensuring the retaining clips are correctly seated. Ensure enough slack is provided in cables to provide full arm articulation

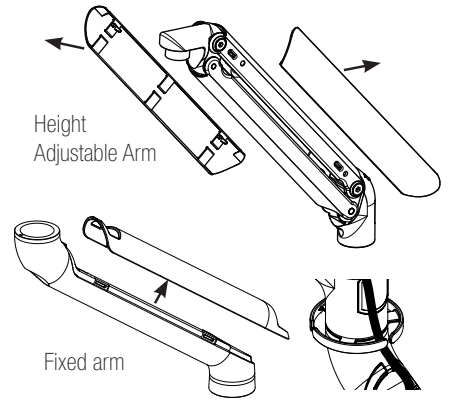

Arm Counterbalance Adjustment:

1. With the monitor installed on the arm, locate the counterbalance adjusting screw
2. If the adjustable arm lowers under the weight of the monitor, using the 1/4" Allen Key, turn the screw counter clockwise in the direction of the + arrow until balanced. If the monitor is difficult to lower or lifts by itself, turn the adjustment screw clockwise in the direction of the - arrow, until the arm is counterbalanced. Note: Use the gauge at the rear of the arm to assist in setting up multiple arm installations

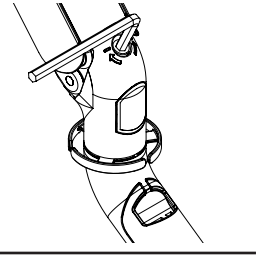

Rotation Limiter:

To limit the arm rotation to 180°, place the arm straight out towards the front edge of the work surface, locate the arm rotation limiting screw on the base & using the 1/8" Allen key tighten clockwise to engage lock. Do not over tighten

CAUTION: For screen loads 20 lbs. or higher, the Rotation Limiter must be engaged to keep the load properly supported above the work surface.

